

# LED Recessed Panel

## Specification Sheet



150+  
EMPLOYEES



3500+  
TOOLINGS



100%  
EXPORT



10+  
YEARS

*Your reliable partner, professor who focus on customized  
linear lighting In house production since 2008*

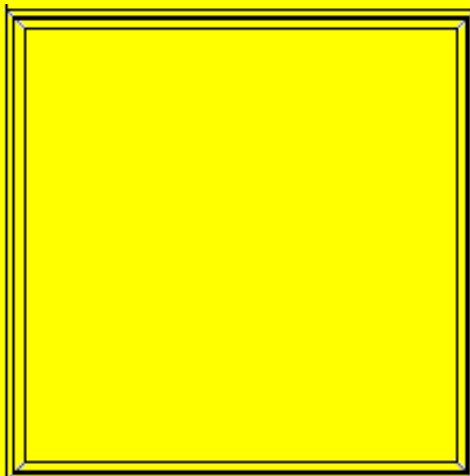

## PRODUCT DESCRIPTION

The LED back-lit panel light, the design of the ultra thin lamp body can be installed in a dark fashion without space, high brightness and strong stability, which will make your space elegant. Create a productive, comfortable atmosphere through enhanced light quality and distribution ensure to provide you better, and healthier lighting. It has a modern design and is easy to install. Ideal for both new construction and remodel in commercial office spaces, schools, healthcare facilities, and retail merchandising areas.

## FEATURES:

- Simple structure, low failure rate, easy to maintain and repair.
- Wide PCB of light sources (SMD) with super heat radiation.
- Energy saving up to 90% compared to traditional bulbs.
- No LGP inside, no worry about the yellowish problem of conventional edge-lit LED panels.
- Flicker free, releasing eye fatigue.
- PMMA optic lenses with high light transmission rate, and larger beam angle.
- Instant start, reaching full brightness within 0.5 seconds.
- Eco-friendly, no harmful elements.
- Active power factor correction design, high performance, high efficiency, low THD.
- Wide range of input voltage: AC120-277V.
- 0-10V / PWM / RX dimming functions, compatible with most dimmers on the market.
- Ambient Temperature: -30 ~ 40 °C (-22° F to +104° F)

## APPLICATIONS:

Retail/Schools/Offices  
Healthcare/Conference rooms  
Hospitality/Corridors  
Reception areas/Foyer  
Library



OPTIONS:	Order Code
AC347-480V High Voltage	347V
Occupancy Sensor	OS
Daylight Harvesting	DH
Emergency Backup	EM
CCT 3000K,3500K,4000K,5000K	30/35/40/50



## ORDERING: (KK=VK, 3 CCT Tunable 35K, 40K and 50K)

Item	Watts	Efficacy	Lumens	CRI	Voltage	Dimension(L*W*H):Inch		
MX879CLM02522BVKD1A	25/30/36W	110lm/w	2750-3960lm	>80	120-277V	23 6/8	23 6/8	1 6/8
MX879CLM02514BVKD1A	25/30/36W	110lm/w	2750-3960lm	>80	120-277V	47 6/8	11 6/8	1 6/8
MX879CLM04024BVKD1A	40/45/50W	110lm/w	4400-5500lm	>80	120-277V	47 6/8	23 6/8	1 6/8

\*Please contact your Brandon representative to order products that don't have order codes listed here or any info required

\*Due to continuing product improvements, Brandon Lighting reserves the right to change the specifications without notice.

## Illustration

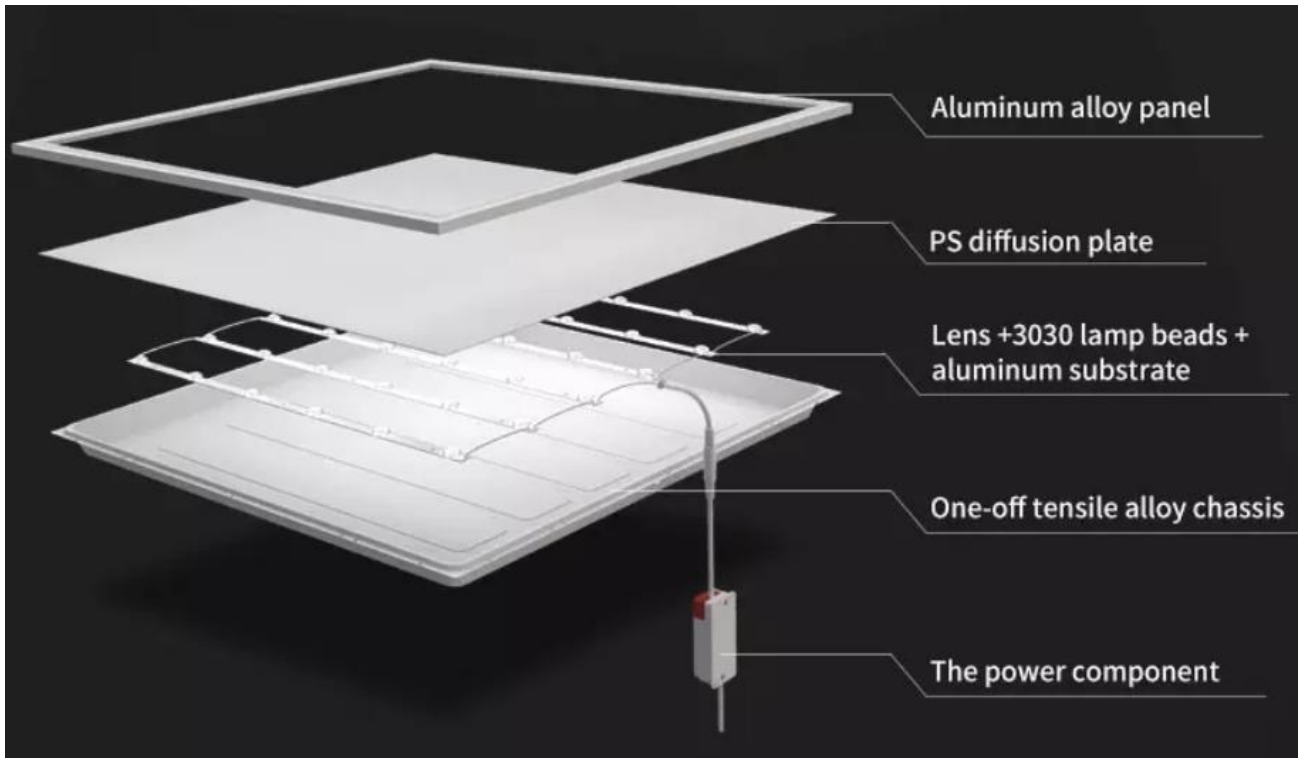

## Installation

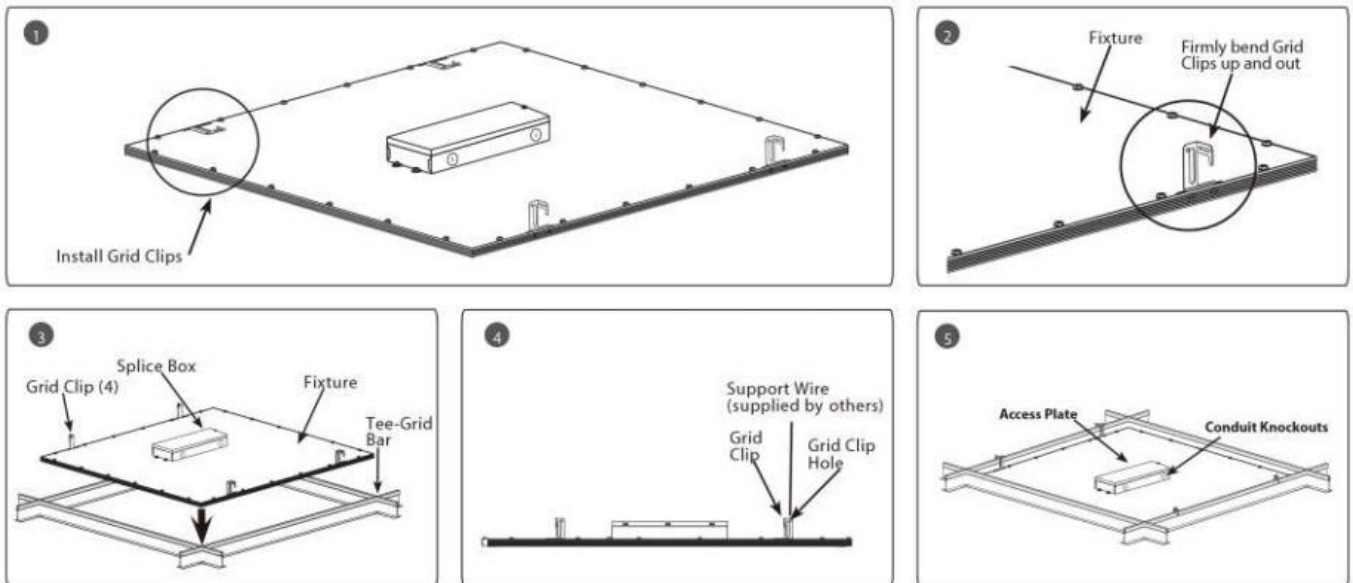

\*Please contact your Brandon representative to order products that don't have order codes listed here or any info required

\*Due to continuing product improvements, Brandon Lighting reserves the right to change the specifications without notice.